

PROPOSED LAY OUT PLAN OF " GLF FARMS "

AT VILLAGE- RAMJIPURA NEWTA, KHASRA NO- 219,220,221,222, NEAR
MAHINDRA WORLD CITY (SEZ) SANGANER, JAIPUR (RAJSTHAN)
Under:- THE RAJHANS CO-OPERATIVE HOUSING SOCIETY
LTD. JAIPUR Regd No.- 1617/L

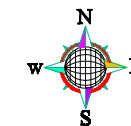

ROAD 100'-0" WIDE

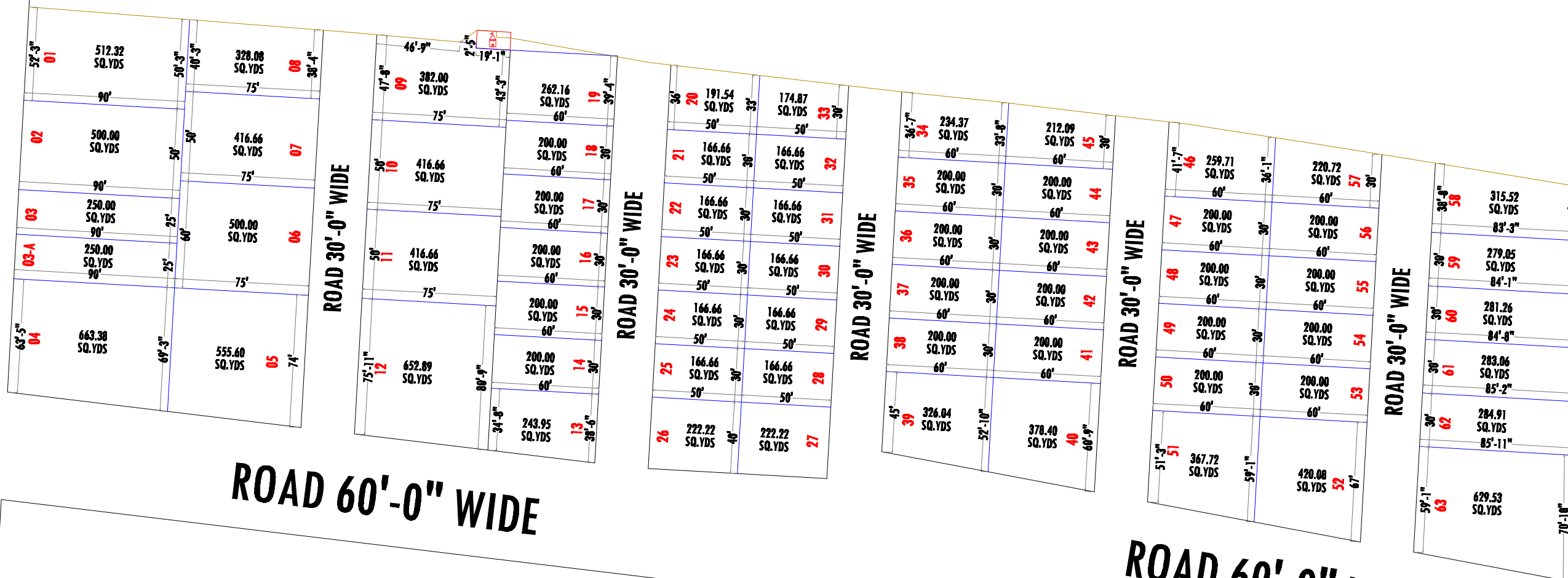

ROAD 60'-0" WIDE

ROAD 60'-0" WIDE